



SHARPn Summit

Travel Essentials Guide

June 11-12, 2011

Rochester, Minnesota



Awardee of The Office of the National Coordinator for Health Information Technology

CONTENTS

Meeting Location 3

HOTEL INFORMATION 3

 Parking..... 4

TRANSPORTATION 4

 Airports 4

 Ground Transportation from Minneapolis to Rochester 5

 Ground Transportation in Rochester..... 6

LOCAL AREA Information 7

RESTAURANTS AND DINING 8

MAPS AND DRIVING DIRECTIONS 13

 Minneapolis Airport to the Broadway Avenue 13

 Rochester Airport to either Hotel..... 14

 University Square Fourth Floor (Meeting Site) 15

Emergency/Urgent Contacts..... 16

MEETING LOCATION



University of Minnesota – Rochester
111 South Broadway, 4th Floor
Rochester, MN 55904

HOTEL INFORMATION

Guest rooms have been reserved at DoubleTree and Hilton Garden Inn.

DoubleTree by Hilton Rochester/Mayo Clinic Area

150 South Broadway
Rochester, MN 55904



For reservations please call the hotel direct at 507-281-8000 and ask for the “Area 4 SHARP Face to Face Conference” block.

http://doubletree.hilton.com/en/dt/groups/personalized/R/RSTDTDT-SHA-20120610/index.html?WT.mc_id=POG

Please call prior to May 20th as the group rate may not be available after this date.

Check in: 3:00 pm Check out: 1:00 pm

Hilton Garden Inn Rochester Downtown

225 South Broadway
Rochester, MN 55904



For reservations please call the hotel direct at 507-285-1234 and ask for the “Area 4 SHARP Face to Face Conference” block.

http://hiltongardeninn.hilton.com/en/gi/groups/personalized/R/RSTRHGI-SHA-20120610/index.html?WT.mc_id=POG

Please call prior to May 20th as the group rate may not be available after this date.

Check in: 3:00 pm Check out: 1:00 pm

Parking

Self-park: \$12.00 (information available at the front desk)

Valet: \$12.00

Shuttle: \$11.50 round trip to and from Rochester International Airport

The following are additional local hotels near the University of Minnesota.

Kahler Grand Hotel

20 Second Avenue SW

Rochester, MN 55902

507-282-2581



Rochester Marriott Hotel

101 First Avenue SW

Rochester, MN 55902

507-280-6000



TRANSPORTATION

Airports

Flying to Rochester usually means taking American / American Eagle or Delta, often connecting in Minneapolis (Delta hub) or Chicago (American hub).

Minneapolis-St Paul International Airport (MSP)

<http://www.mspairport.com>

612-726-5555

Chicago O'Hare International Airport (ORD)

<http://www.flychicago.com/OHare/OhareHomepage.shtm>

773-686-2200

Rochester International Airport (RST)

<http://www.rochesterintlairport.com/>

507-282-2328

Ground Transportation from Minneapolis to Rochester

Rochester is approximately 75 miles SE of Minneapolis. It is a relatively short drive in the event you miss a connection or prefer to rent a car in Minneapolis. Shuttle service is also available.

Transportation Service	Contact Information	Cost																																																																												
<p>Rochester Direct – shuttle service from Minneapolis Airport to Rochester Kahler Grand Hotel (near the DoubleTree)</p>	<p>800-280-9270 ** On-line reservations recommended http://rochesterdirect.hudsonltd.net/res</p> <p>Daily Airport Shuttle Schedule</p> <table border="1" data-bbox="718 659 1066 1419"> <thead> <tr> <th colspan="2">Minneapolis to Rochester</th> </tr> <tr> <th>Departing - Minneapolis</th> <th>Arriving - Rochester</th> </tr> </thead> <tbody> <tr><td>6:45 AM *</td><td>8:15 AM</td></tr> <tr><td>8:15 AM</td><td>9:45 AM</td></tr> <tr><td>9:30 AM</td><td>11:00 AM</td></tr> <tr><td>10:30 AM</td><td>12:00 PM</td></tr> <tr><td>11:15 AM</td><td>12:45 PM</td></tr> <tr><td>12:15 PM</td><td>1:45 PM</td></tr> <tr><td>1:15 PM</td><td>2:45 PM</td></tr> <tr><td>2:15 PM</td><td>3:45 PM</td></tr> <tr><td>3:15 PM</td><td>4:30 PM</td></tr> <tr><td>4:00 PM</td><td>5:15 PM</td></tr> <tr><td>4:30 PM</td><td>6:00 PM</td></tr> <tr><td>5:15 PM</td><td>6:45 PM</td></tr> <tr><td>6:00 PM</td><td>7:30 PM</td></tr> <tr><td>7:00 PM</td><td>8:30 PM</td></tr> <tr><td>8:15 PM</td><td>9:45 PM</td></tr> <tr><td>9:15 PM</td><td>10:45 PM</td></tr> <tr><td>10:30 PM **</td><td>12:00 AM</td></tr> </tbody> </table> <p>* Daily except on Sundays</p> <table border="1" data-bbox="1142 659 1486 1419"> <thead> <tr> <th colspan="2">Rochester to Minneapolis</th> </tr> <tr> <th>Departing - Rochester</th> <th>Arriving - Minneapolis</th> </tr> </thead> <tbody> <tr><td>4:00 AM *</td><td>5:30 AM</td></tr> <tr><td>6:00 AM</td><td>7:30 AM</td></tr> <tr><td>7:00 AM</td><td>8:30 AM</td></tr> <tr><td>7:45 AM</td><td>9:15 AM</td></tr> <tr><td>8:15 AM</td><td>9:45 AM</td></tr> <tr><td>8:45 AM</td><td>10:15 AM</td></tr> <tr><td>10:00 AM</td><td>11:30 AM</td></tr> <tr><td>11:00 AM</td><td>12:30 PM</td></tr> <tr><td>12:00 PM</td><td>1:30 PM</td></tr> <tr><td>12:45 PM</td><td>2:15 PM</td></tr> <tr><td>1:45 PM</td><td>3:15 PM</td></tr> <tr><td>2:15 PM</td><td>3:45 PM</td></tr> <tr><td>3:00 PM</td><td>4:30 PM</td></tr> <tr><td>3:45 PM</td><td>5:15 PM</td></tr> <tr><td>4:45 PM</td><td>6:15 PM</td></tr> <tr><td>6:15 PM</td><td>7:45 PM</td></tr> <tr><td>7:15 PM **</td><td>8:45 PM</td></tr> </tbody> </table> <p>** Daily except on Saturdays</p>	Minneapolis to Rochester		Departing - Minneapolis	Arriving - Rochester	6:45 AM *	8:15 AM	8:15 AM	9:45 AM	9:30 AM	11:00 AM	10:30 AM	12:00 PM	11:15 AM	12:45 PM	12:15 PM	1:45 PM	1:15 PM	2:45 PM	2:15 PM	3:45 PM	3:15 PM	4:30 PM	4:00 PM	5:15 PM	4:30 PM	6:00 PM	5:15 PM	6:45 PM	6:00 PM	7:30 PM	7:00 PM	8:30 PM	8:15 PM	9:45 PM	9:15 PM	10:45 PM	10:30 PM **	12:00 AM	Rochester to Minneapolis		Departing - Rochester	Arriving - Minneapolis	4:00 AM *	5:30 AM	6:00 AM	7:30 AM	7:00 AM	8:30 AM	7:45 AM	9:15 AM	8:15 AM	9:45 AM	8:45 AM	10:15 AM	10:00 AM	11:30 AM	11:00 AM	12:30 PM	12:00 PM	1:30 PM	12:45 PM	2:15 PM	1:45 PM	3:15 PM	2:15 PM	3:45 PM	3:00 PM	4:30 PM	3:45 PM	5:15 PM	4:45 PM	6:15 PM	6:15 PM	7:45 PM	7:15 PM **	8:45 PM	<p>\$29.00 one way, \$55.00 round trip</p> <p>Senior prices \$27.00 one way, \$52.00 round trip</p>
Minneapolis to Rochester																																																																														
Departing - Minneapolis	Arriving - Rochester																																																																													
6:45 AM *	8:15 AM																																																																													
8:15 AM	9:45 AM																																																																													
9:30 AM	11:00 AM																																																																													
10:30 AM	12:00 PM																																																																													
11:15 AM	12:45 PM																																																																													
12:15 PM	1:45 PM																																																																													
1:15 PM	2:45 PM																																																																													
2:15 PM	3:45 PM																																																																													
3:15 PM	4:30 PM																																																																													
4:00 PM	5:15 PM																																																																													
4:30 PM	6:00 PM																																																																													
5:15 PM	6:45 PM																																																																													
6:00 PM	7:30 PM																																																																													
7:00 PM	8:30 PM																																																																													
8:15 PM	9:45 PM																																																																													
9:15 PM	10:45 PM																																																																													
10:30 PM **	12:00 AM																																																																													
Rochester to Minneapolis																																																																														
Departing - Rochester	Arriving - Minneapolis																																																																													
4:00 AM *	5:30 AM																																																																													
6:00 AM	7:30 AM																																																																													
7:00 AM	8:30 AM																																																																													
7:45 AM	9:15 AM																																																																													
8:15 AM	9:45 AM																																																																													
8:45 AM	10:15 AM																																																																													
10:00 AM	11:30 AM																																																																													
11:00 AM	12:30 PM																																																																													
12:00 PM	1:30 PM																																																																													
12:45 PM	2:15 PM																																																																													
1:45 PM	3:15 PM																																																																													
2:15 PM	3:45 PM																																																																													
3:00 PM	4:30 PM																																																																													
3:45 PM	5:15 PM																																																																													
4:45 PM	6:15 PM																																																																													
6:15 PM	7:45 PM																																																																													
7:15 PM **	8:45 PM																																																																													

Transportation Service	Contact Information	Cost
Jefferson Bus Lines - Minneapolis	800-767-5333	Tickets available at the Rochester Direct counter

Car Rental at the Minneapolis Airport	Contact Information	
Alamo	800-327-9633	<p>Terminal 1-Lindbergh: Car rental counters are located on the second and third levels between the Blue and Red parking ramps. Passengers can take the underground tram to the Blue and Red parking ramps and then take an elevator to the second or third floor.</p> <p>Terminal 2-Humphrey: Car rental counters are located in the Ground Transport Center on the ground level of the Purple parking ramp directly across from the terminal building.</p>
Avis	800-831-2847	
Budget	800-527-0700	
Dollar	800-800-4000	
Enterprise	800-325-8007	
Hertz	800-654-3131	
National	800-227-7368	

Ground Transportation in Rochester

Both hotels have an arrangement with Rochester Transportation Systems (RTS) to provide shuttle service between the airport and the hotel. The shuttle is located just outside baggage claim. Inform the shuttle driver that you are going to either the DoubleTree or Hilton Garden Inn; no payment is needed. When you arrive at the hotel the driver will notify the front desk of your transportation on RTS. The shuttle is also available for your return trip to the airport. Fees for this service are offered at 50% off and will appear on your hotel bill. Round trip fee is \$11.50.

Transportation Service	Comments	Phone
Rochester Transportation Systems	Taxi and airport shuttle	507-282-2222
Rochester Med City Cab	Taxi	507-282-8294

Car Rental at the Rochester Airport	Contact Information	Car rental counters are located across from baggage claim.
Avis	800-331-1212	
Budget	800-527-0700	
Enterprise	800-325-8007	
Hertz	800-654-3131	
National	800-222-9058	

LOCAL AREA INFORMATION

- Minnesota
 - Minnesota tourism <http://www.exploreminnesota.com>
- Rochester
 - City Website <http://www.rochestercvb.org/>
 - Calendar of events <http://www.rahamrochester.com/calendar.asp>
 - City map, including dining and landmarks <http://www.rochestercvb.org/planning/citymap.asp>
 - Bike/Walking paths <http://www.rahamrochester.com/WalkingTours.html>
<http://www.ci.rochester.mn.us/departments/parl/trails/index.asp>
 - Silver Lake Bike and Boat rental <http://www.silverlakefun.com>

RESTAURANTS AND DINING

Rochester has many restaurants, most of which are mid-range and geared toward visiting patients and their families. This table lists a selection of restaurants that are relatively close to downtown. Please consult the phone book to find additional choices, including many chains not listed below.

Cost Key: \$ = under \$12 \$\$ = \$13-20 \$\$\$ = \$21-30

Cost	Recommended	Restaurant	Address Phone	Breakfast	Lunch	Dinner	Sub = Subway Sky = Skyway	Walk (W) or Taxi (T)	Wheelchair Accessible	Kid Friendly	Reservations	Vegetarian	Comments
<i>FINE DINING</i>													
\$\$	*	300 First	300 1st Ave NW 507-281-2451		X	X		W/T	X	X		X	
\$\$	*	Chesters Kitchen & Bar	111 S. Broadway 507-424-1211		X	X		W	X	X		X	University Square
\$\$	*	City Café	216 1st Ave SW 507-289-1949		X	X		W	X	X		X	
\$\$	*	Jaspers Bistro	14 Historic 3rd St SW 507-280-6446		X	X		W	X	X	X	X	Alsatian (French/German)
\$\$\$	*	Pescara	150 S. Broadway 507-280-6900	X	X	X		W	X	X	X	X	DoubleTree Hotel
\$\$	*	Prescotts	1201 S Broadway 507-536-7775			X		T	X		X	X	
\$\$	*	Redwood Room	300 1st Ave NW 507-281-2978			X		W/T	X			X	
\$\$	*	Sontes	4 3rd St SW 507-292-1628			X		W	X		X	X	Tapas & good wines

<i>STEAK HOUSES</i>													
\$\$	*	Jenpachi Steak House	3160 Wellner Drive NE 507-292-1688			X		T	X	X	X	X	Japanese-style table-side cooking
\$\$		Michaels	15 S Broadway 507-288-2020		X	X		W	X	X	X	X	
\$\$		Outback Steak House	1201 S Broadway 507-252-1150			X		T	X	X	X	X	
\$\$	*	Whiskey Creek	1705 S Broadway 507-288-6551		X	X		T	X	X			BBQ
<i>MEXICAN</i>													
\$	*	Azteca	18 19th St SE 507-281-0121		X	X		T		X		X	
\$	*	Dos Amigos	20 4th St SE 507-282-3300		X	X		W	X	X		X	
\$		Fiesta Express	100 1st Ave (food court) NA				Sky						
<i>AMERICAN/DELI</i>													
\$		B!stro	100 1st Ave (food court) 507-252-1698		X		Sky	W	X	X			
\$	*	Canadian Honker	1201 2nd St SW 507-282-6572	X	X	X		W/T	X	X		X	Coconut cake
\$	*	Chocolatiere Stam	111 S Broadway 507-536-2722		X	X	Sky	W	X	X			Great desserts, University Square
\$	*	City Market	212 1st Ave SW 507-536-4748		X	X		W		X		X	Excellent deli
\$		Daubes Down Under	155 1st Ave SW 507-252-8878	X	X		Sub	W	X	X			Pastries
\$		Dish It Up	100 1st Ave (food court) 507-292-1100		X		Sky	W	X	X			
\$		Erbert & Gerberts	21 2nd St SW 507-280-0060		X	X		W		X		X	
\$\$		Famous Dave's	431 16th Ave NW 507-282-4200		X	X		T	X	X			BBQ
\$		Jimmy John's	9 3rd Ave NW 507-289-9900		X			W					

\$		John Hardys	1940 S. Broadway 507-281-1727		X	X		T	X	X		X	BBQ
\$		John Hardys	929 West Frontage Rd 507-288-3936		X	X		T	X	X		X	BBQ
\$		Kari-O's	101 1st Ave SW 507-280-7887	X	X		Sub	W	X	X			
\$		Nelson's Cheese	210 N Broadway 507-288-1888		X			W	X	X		X	
\$		Newt's Express	100 1st Ave (food court) NA		X		Sky	W		X			Burgers only
\$		Regals Eatery	100 1st Ave (food court) 507-358-1857		X		Sky	W	X	X			
\$		Salad Brothers	111 S Broadway 507-289-1560		X		Sky	W	X	X		X	University Square
\$		The Sandwich Shop	100 1st Ave (food court) NA				Sky						
\$		Subway	2660 S Broadway 507-282-3582	X	X		Sub	W	X	X		X	
\$\$		Twigs Tavern and Grill	401 6th St SW 507-288-0206		X	X		W/T	X	X	X	X	Hot rock cooking
SEAFOOD													
\$		Red Lobster	195 S Broadway 507-287-9710		X	X		W	X	X	X	X	
ITALIAN/PIZZA													
\$		Bilotti's Italian Village	304 1st Ave SW 507-282-8669		X	X		W	X	X		X	
\$\$		Olive Garden	380 17th Ave NW 507-288-8722		X	X		T	X	X	X	X	
\$		O'Neils Pizza	1201 S Broadway # 24 507-529-1200										
\$\$	*	Victorias	7 1st Ave SW 507-280-6232		X	X		W	X	X	X	X	
\$		Victorias Express	100 1st Ave (food court) NA		X		Sky	X	X	X		X	Great salads
\$		Z Pizza	111 S Broadway 507-424-0440		X		Sky						University Square

<i>INDIAN</i>													
\$\$	*	India Curry House	1647 S Broadway 507-288-5001		X	X		T	X	X		X	Lunch buffet
\$		India Curry House	100 1st Ave (food court) 507-252-0178		X		Sky	W	X	X		X	Lunch buffet
\$		India Garden	1107 N Broadway 507-288-6280										
\$		Kabob	108 East Center St 507-288-2181		X	X		W	X				Lunch buffet
<i>CHINESE/JAPANESE</i>													
\$		China Star	405 1st Ave SW 507-281-0014		X	X		W	X	X			
\$		Hunan Garden	1120 NW 7th St 507-285-1438		X	X		T	X	X		X	
<i>PUBS/GRILLS</i>													
\$		Beetles Bar & Grill	230 20th Ave SW 507-529-9599		X	X		T	X	X		X	
\$		Brothers Bar & Grill	812 S Broadway 507-281-8902		X	X		W/T	X	X			
\$\$	*	McGoons Pub	7 Second St SW 507-288-8130		X	X		W	X	X		X	
\$	*	Newt's	216 ½ 1st Ave SW 507-289-0577		X	X		W		X			Great burgers
\$		Whistle Binkies	247 Woodlake Dr SE 507-424-1227		X	X		T	X	X			Nearly 400 types of beer
\$		Whistle Binkies	3120 Wellner Dr NE 507-289-9200		X	X		T	X	X			Nearly 400 types of beer
<i>FAMILY DINING</i>													
\$		Applebees	320 Apache Mall 507-252-0155		X	X		T	X	X		X	
\$		Bakers Square	819 Apache Ln SW 507-252-1224	X	X	X		T	X	X	X	X	
\$		Denny's	1226 S Broadway 507-288-6482	X	X	X		T	X	X		X	

\$		Old Country Buffet	1300 Salem Rd SW 507-289-4617		X	X		T	X	X		X	
\$		Pannekoeken House	6 1st Ave NW 507-287-0722	X	X	X		W	X	X		X	
\$		Perkins	1818 S Broadway 507-288-9400	X	X	X		T	X	X			
\$		TGI Friday's	300 Hwy 52 N 507-281-2020		X	X		T	X	X		X	
<i>COFFEE SHOPS</i>													
\$		Bruggers Bagels	155 1st Ave SW Suite 140 507-424-4777	X	X	X	Sub	W	X	X			
\$	*	Caribou Coffee	101 1st Ave SW 507-288-6230	X	X	X	Sub	W	X	X			
\$		Starbucks	150 S Broadway NA	X	X	X	Sky	W	X	X			DoubleTree Hotel
\$		Starbucks	20 2nd Ave SW 507-285-2781	X	X	X		W	X				

MAPS AND DRIVING DIRECTIONS

Minneapolis Airport to the Broadway Avenue

1. Head northwest on Glumack Dr (at MSP airport) 0.2 mi
2. Slight left to stay on Glumack Dr 1.1 mi
3. Merge onto MN-5 W via the ramp to Bloomington/I-494 1.1 mi
4. Take the ramp onto I-494 E 7.7 mi
5. Take exit 66 to merge onto US-52 S toward Rochester 70.6 mi
6. Take exit 55B for 2nd St SW 0.3 mi
7. Turn left at 2nd St SW 1.3 mi

The DoubleTree is located at 150 S Broadway – left at Broadway Avenue

The Hilton Garden Inn is located at 225 S Broadway – right at Broadway Avenue



To Rochester

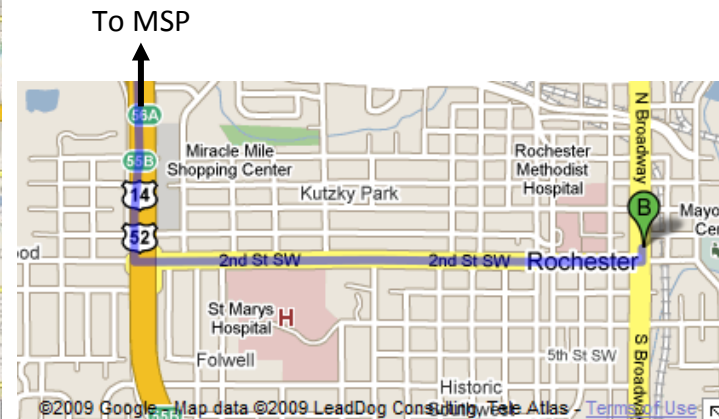

To MSP

Rochester Airport to either Hotel

1. Head southeast on Helgerson Dr SW toward Air Commerce Dr SW 0.4 mi
2. Slight right to stay on Helgerson Dr SW 0.3 mi
3. Turn right at County Hwy-16/County Rd-16 SW 0.6 mi
4. Turn left to merge onto S Broadway/US-63 7.5 mi

The DoubleTree is located at 150 S Broadway on the right

The Hilton Garden Inn is located at 225 S Broadway on the left

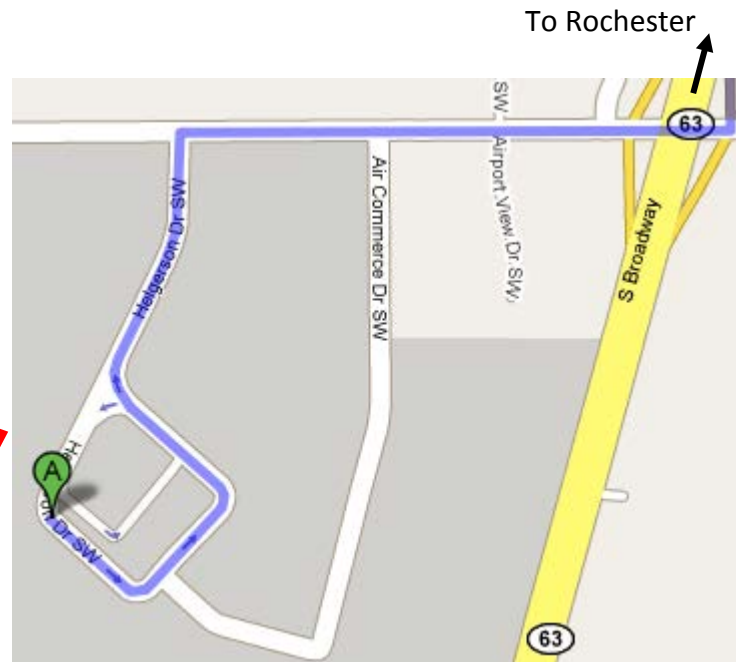
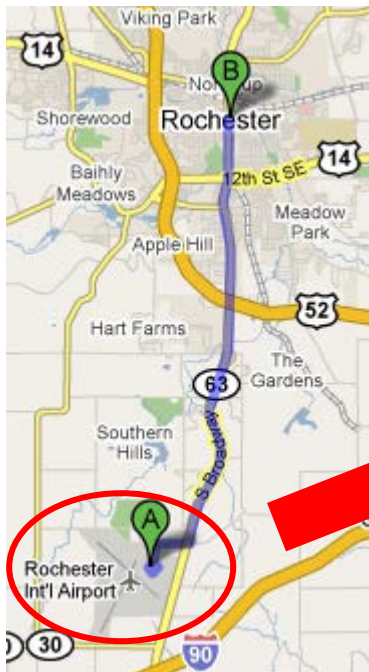

University Square Fourth Floor (Meeting Site)

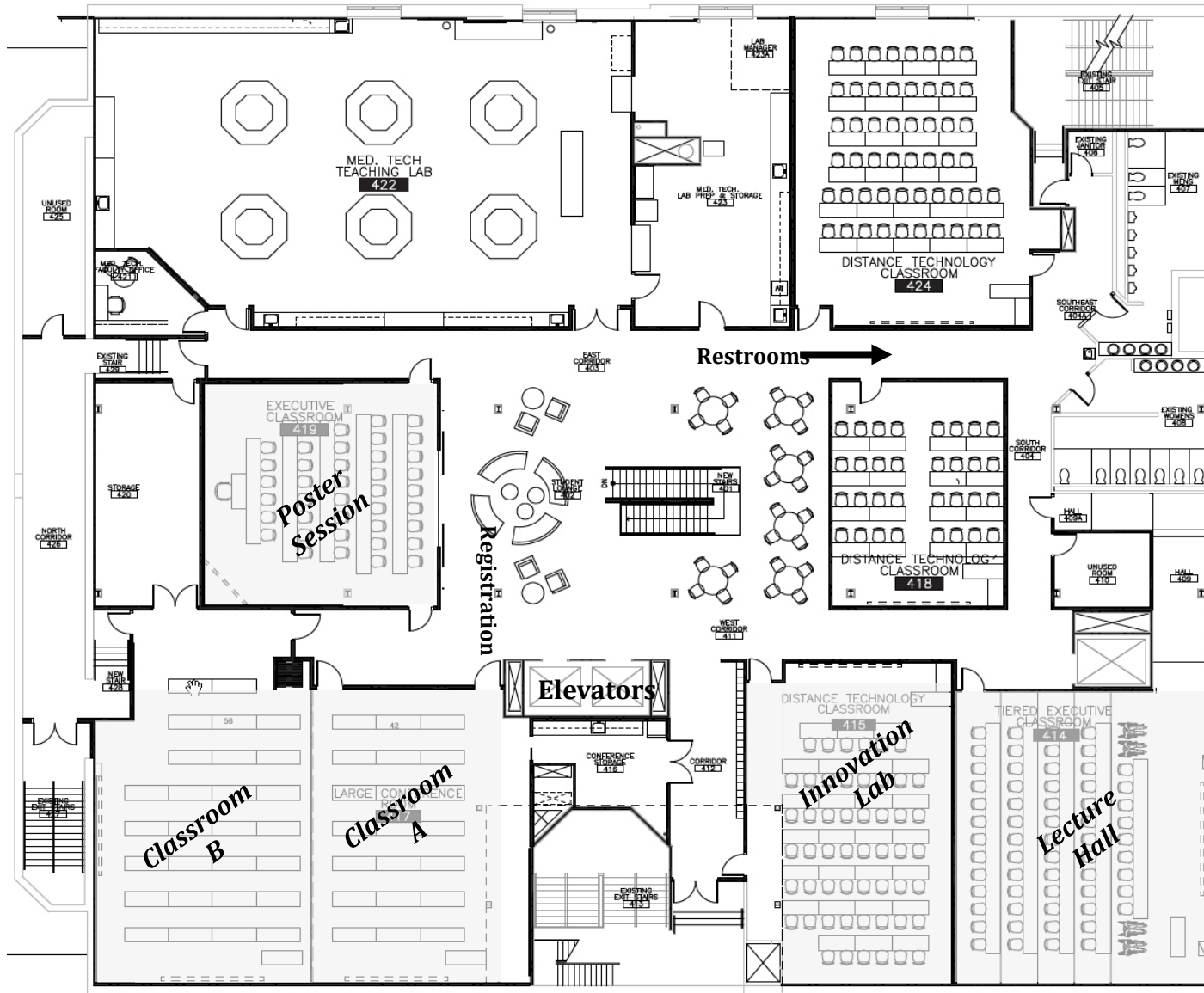

The DoubleTree Hotel is connected to University Square by skyway.

The meeting will be held on the 4th floor of University Square in Conference rooms 414, 415, 417 and 419.

Elevators are the most direct. Alternatively, escalators are available to the 3rd floor entrance to the University of Minnesota, Rochester facilities, and then stairs or elevators can be taken to the 4th floor.

EMERGENCY/URGENT CONTACTS

For medical, fires, or police-related emergencies, dial 911.

Name	Role	Affiliation	Email	Phone Number
Lacey Hart	Program Director	Mayo Clinic	hart.lacey@mayo.edu	507-293-3780 (office)
Erin Martin	SHARP Admin	Mayo Clinic	martin.erin@mayo.edu	507-284-9135 (office)

Service	Address	Phone Number
Rochester Airport Customer Service		507-282-2328
Police Non-Emergency Phone Number (active emergency call 911)		507-328-6888
Mayo Clinic Pharmacy	Mayo Building, Subway level	507-284-2021 Fax: 507-289-0588
Weber and Judd Pharmacy	101 1 st Ave Southwest – Subway level of Marriott Place	507-289-0716 Fax: 507-289-0588